

| Proposed Memorandum of Easements   |   |                            |   |
|--|---|----------------------------|---|
| Nature   | Servient Tenement (Burdened Land)                   |                            | Dominant Tenement (Benefitted Land)   |
|  | Lot No  | Shown                      |   |
| Right of way, rights to drain water & sewage & rights to convey water, electricity & telecommunications. | Lot 677<br>Lot 678<br>Lot 679<br>Lot 680<br>Lot 681 | BU<br>BV<br>BW<br>BX<br>BY | Lots 678 - 681<br>Lots 677, 679 - 681<br>Lots 677, 678, 680 & 681<br>Lots 677 - 679 & 681<br>Lots 677 - 680 |

**Stage 9B**

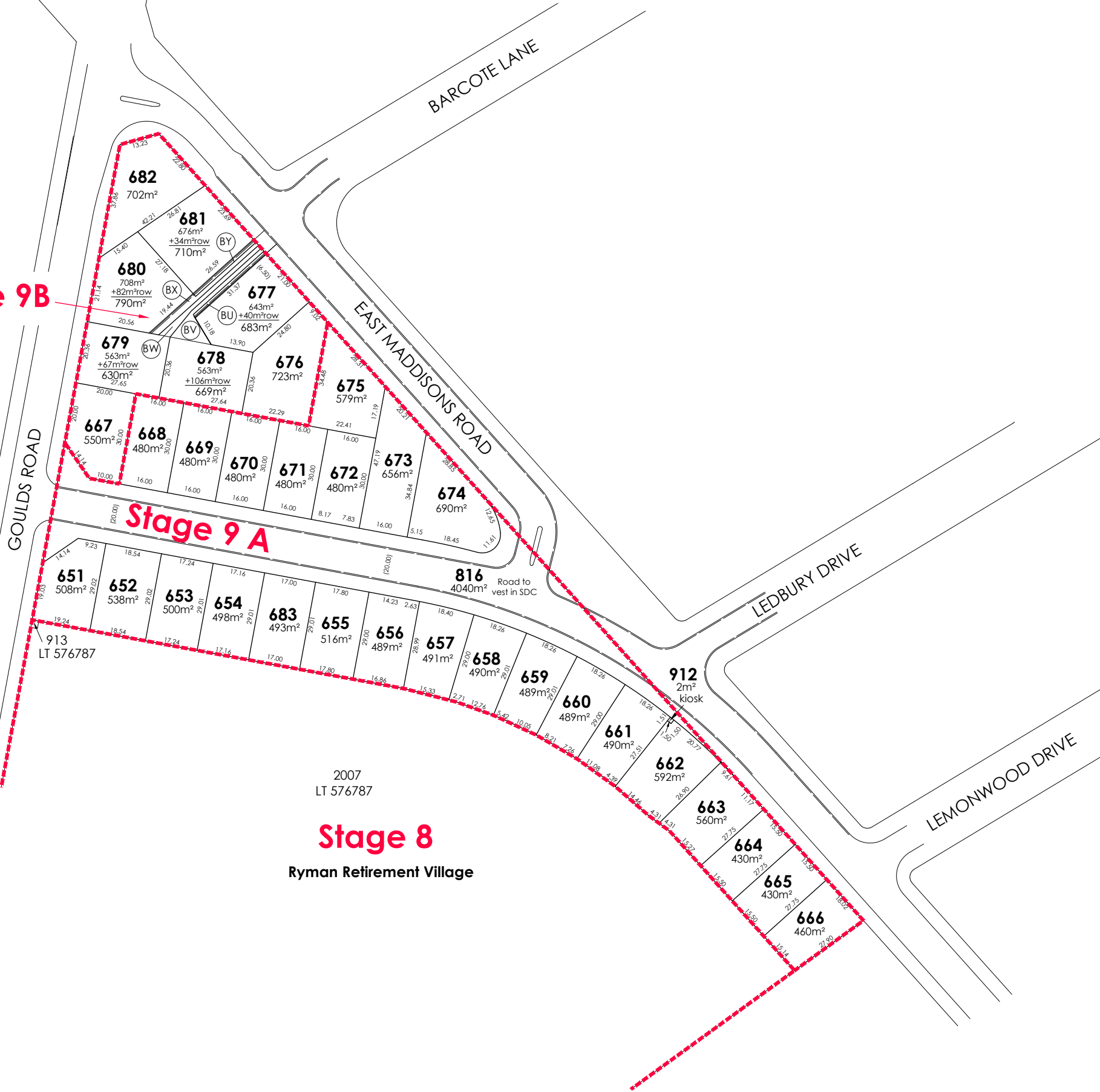

**Stage 8**  
Ryman Retirement Village

| AMENDMENTS: |          |  |
|-------------|----------|--|
| AMENDMENT   | DATE     | DESCRIPTION                                    |
| R4          | 21/12    | LAYOUT UPDATED, LOT 1 DP 326339 REMOVED        |
| R5          | 12/1/21  | LAYOUT UPDATED, LOTS RENUMBERED                |
| R6          | 3/02/21  | STAGES 1 & 5 AMENDED                           |
| R7          | 1/03/21  | LOTS 171-180 & 190 AMENDED                     |
| R8          | 11/3/21  | LAYOUT UPDATED                                 |
| R9          | 15/3/21  | STAGES 1 & 5 AMENDED                           |
| R10         | 25/3/21  | STAGES 2 & 3 RENUMBERED                        |
| R11         | 1/04/21  | LOTS 668-674 & 676 AMEND, LOTS RENUMBERED      |
| R12         | 12/4/21  | LOTS 667-682 AMENDED                           |
| R13         | 20/4/21  | NO CHANGE THIS SHEET                           |
| R14         | 01/6/21  | NO CHANGE THIS SHEET                           |
| R15         | 22/6/21  | NO CHANGE THIS SHEET                           |
| R16         | 28/7/21  | LOTS 651 & 663 - 667 AMENDED                   |
| R17         | 04/8/21  | GAS REMOVED FROM EASEMENT                      |
| R18         | 11/8/21  | KERB ALIGNMENT ADDED                           |
| R19         | 6/10/21  | STAGE 9 AMENDED TO STAGE 9A & 9B               |
| R20         | 15/10/21 | NO CHANGE THIS SHEET                           |
| R21         | 2/11/21  | NO CHANGE THIS SHEET                           |
| R22         | 2/11/21  | NO CHANGE THIS SHEET                           |
| R23         | 19/1/22  | LOTS 683 & 912 ADD. & 655, 708 & 816 AMEND.    |
| R24         | 30/5/22  | NO CHANGE THIS SHEET                           |
| R25         | 16/6/22  | LOTS 662, 663, 683-686 AMENDED & LOT 912 ADDED |

- NOTES:
- 1) Areas and dimensions are approximate & subject to final survey and deposit of plans.
  - 2) Service easements to be created as required.
  - 3) This plan has been prepared for subdivision consent purposes only. No liability is accepted if the plan is used for any other purpose.
  - 4) Any measurements taken from information which is not dimensioned on the electronic copy are at the risk of the recipient.
  - 5) This plan is subject to the granting of subdivision and/or resource consents and should be treated as a proposal until such time as the necessary consents have been granted by the relevant authorities.
  - 6) This plan has been prepared for the use of Hughes Developments Limited only and no liability is accepted in relation to any other parties.
  - 7) Orion kiosk lots have not been shown and are to be created as required following a detail electrical design.

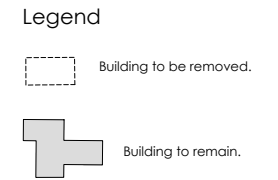

Total Area : 2.2558ha  
Comprised in: RT: Yet to Issue



116 Wrights Road P O Box 679 Christchurch 8140, New Zealand  
Telephone: 03 379-0793 Website: www.dls.co.nz E-mail: office@dls.co.nz

JOB TITLE:  
**Hughes Developments Limited  
South West Stage 9  
Rolleston**

SHEET TITLE:  
**Proposed Subdivision of  
Lot 2008 LT 568215**

DRAWING STATUS:  
**For Subdivision Consent**

SCALE: 1:750@A1 DATE: June 2022  
1:1500@A3

DRAWING No: H.20184 STG9 SW01.0 SHEET No: R25  
DRAWN: JG