

## Earthworks - NZS4431:1989 Certification

## APPENDIX A

### STATEMENT OF SUITABILITY OF EARTHFILL FOR RESIDENTIAL DEVELOPMENT

To **Selwyn District Council**  
**PO Box 90**  
**ROLLESTON, 7643**  
**Attention: Development Engineer**

### STATEMENT OF SUITABILITY OF EARTH FILL FOR RESIDENTIAL DEVELOPMENT

Subdivision **Faringdon South West Stage 1**  
Owner/Developer **R D Hughes Development Ltd**  
Location **Selwyn Road, Rolleston**

The earth fill shown on the attached plan Davie Lovell-Smith Ltd, South West Faringdon Stage 1 - Earthworks As-built dated December 2021 has been placed in compliance with the terms of NZS 4431:1989.

While work was in progress I retained as my inspecting engineer (or staff under his control) the engineer named below who is registered in terms of the Engineers Registration Act 1924.

**Jamie Verstappen (Registration Number 1013462)**

Address: **C/- Davie, Lovell-Smith Limited, PO Box 679, Christchurch**

During the work, the inspecting engineer or staff under his control made periodic visits of inspection to the site as detailed in this report, Contract No 20256-001, which is attached. Details of the soil testing carried out to check the quality of the fill by the inspecting engineer and his testing agency are also included.

The plan Davie Lovell-Smith Ltd South West Faringdon Stage 1 - Earthworks As-built shows the building lots within the Subdivision site which are affected by filling.

In the opinion of the inspecting engineer the following special limitations should be observed:

- Foundation design in all filled lots to take into account the location of the cut/fill interface (to be confirmed on site) and design appropriately.
- This report deals with the fill material only, not the underlying existing material

This certification, that the earth fills have been placed in compliance with the terms of NZS:4431 does not remove the necessity for the normal inspection and design of foundations as would be made in natural ground.

.....  
Chartered Professional Engineer

on behalf of: R D Hughes Development Limited

Date:

17/12/21

## Earthworks - Earthfill As-built plans

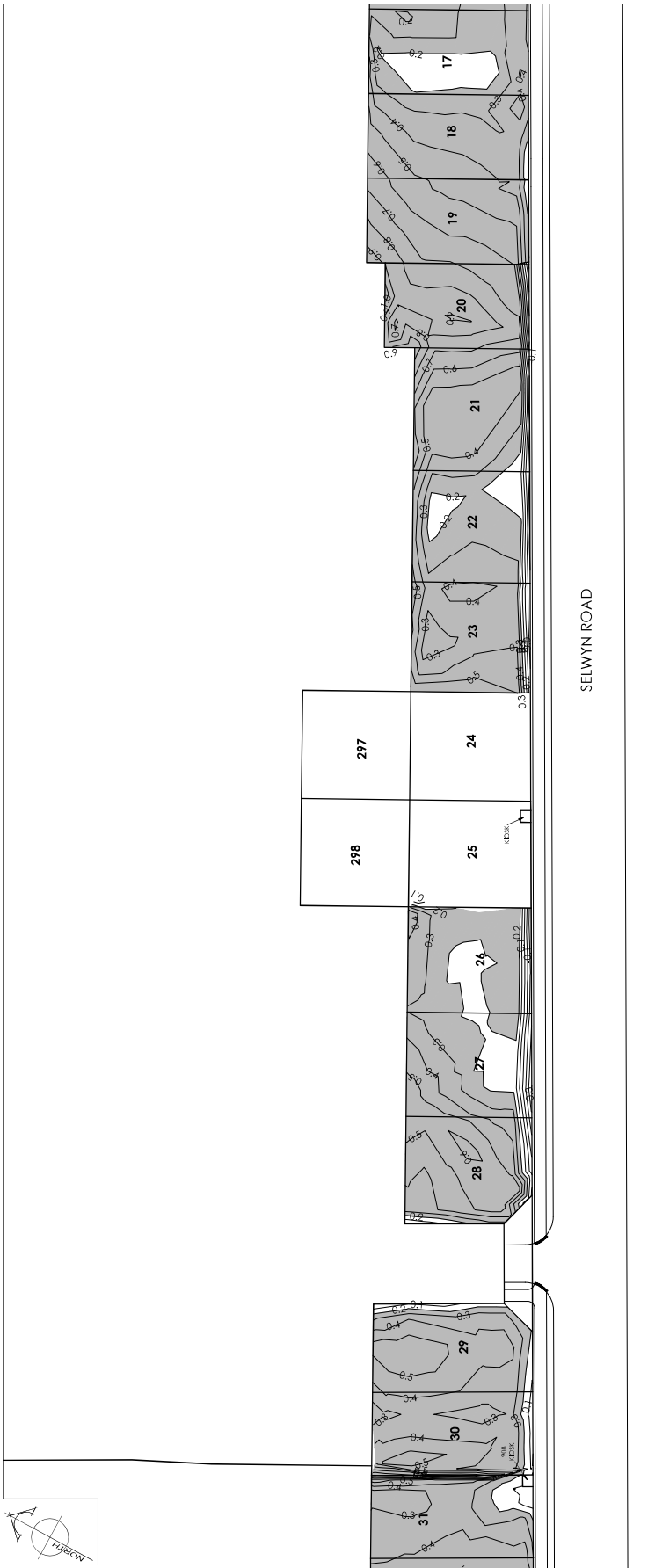
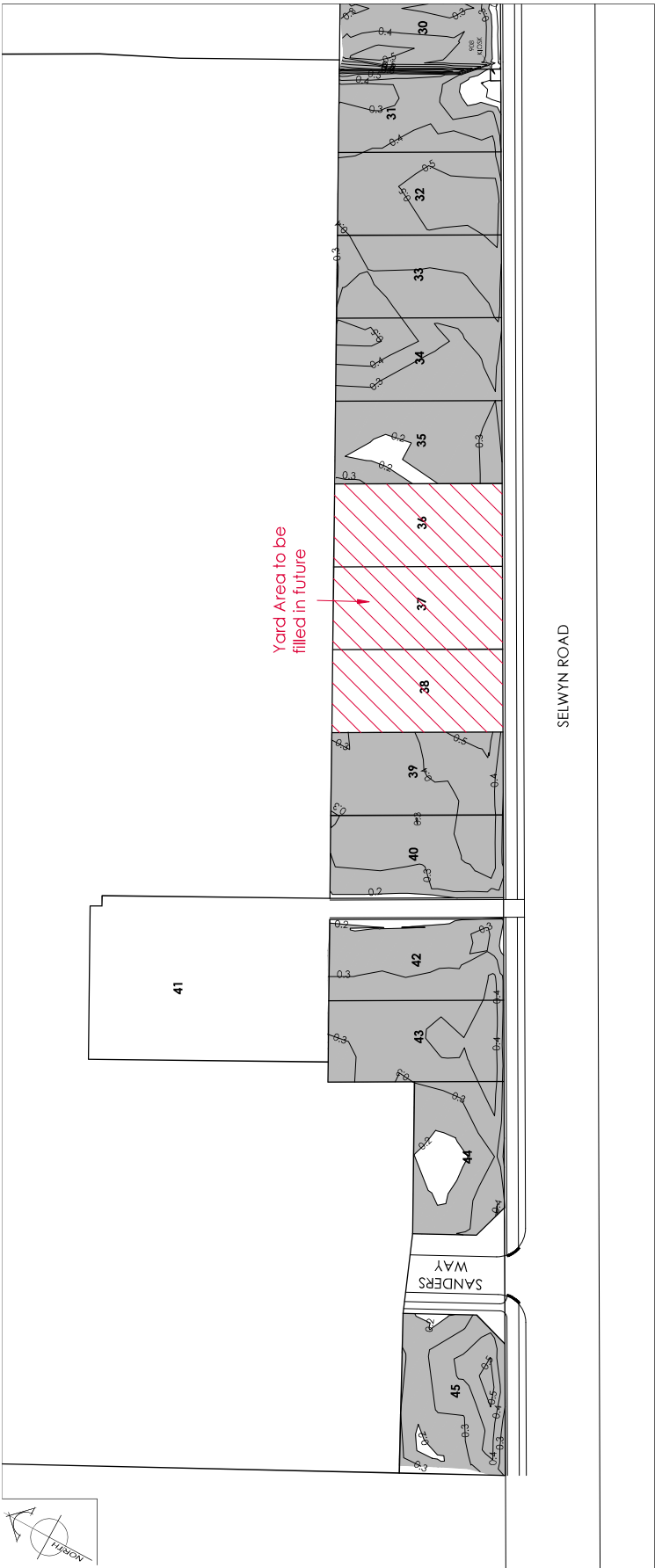

AMENDMENTS		DATE	DESCRIPTION
1		10.12.21	EARTHFILL ASBUILT UPDATED

NOTES:

- This plan has been prepared for earth fill asbuilt purposes only. No liability is accepted if the plan is used for any other purpose.
- Any measurements taken from information which is not dimensioned on the electronic copy are at the risk of the recipient.
- All loading and footpath information is design.

LEGEND
CONTOURS SHOWN ARE APPROXIMATELY CUT (+ve) AND FILL (-ve) AT 0.1m INTERVALS.
CUT
ASBUILT FILL ± 0.2m
DESIGN KERB
DESIGN FOOTPATH



**DAVIE LOVELL-SMITH**  
PLANNING SURVEYING ENGINEERING

116 Wright Road  
P.O. Box 679 Christchurch 8142, New Zealand  
Telephone: 03 379 4773 Website: [www.dls.co.nz](http://www.dls.co.nz) E-mail: [info@dls.co.nz](mailto:info@dls.co.nz)

JOB TITLE	South West Faringdon Stage 1 RC 215485 & RC 215810
SHEET TITLE	Earthworks Asbuilt
DRAWING STATUS	Asbuilt
SCALE: 1:500 @ A1	DATE: December 2021
CAD FILE: 1:1000 @ A3	DRAWN: GC
DRAWING NO: H.20256.AB.EW01	SHEET NO: R1

AMENDMENTS		DATE	DESCRIPTION
AMENDMENT	R1	10.12.21	EARTHWORK ASBUILT UPDATED
NOTES:			
1. This plan has been prepared for earth fill/asbuilt purposes only. No liability is accepted if the plan is used for any other purpose.			
2. Any measurements taken from information which is not dimensioned on the electronic copy are at the risk of the recipient.			
3. All loading and footpath information is design.			

LEGEND	
CONTOURS SHOWN ARE APPROXIMATELY CUT (+ve) AND FILL (-ve) AT 0.1m INTERVALS.	
	CUT
	ASBUILT FILL ± 0.2m
DESIGN KERB	
DESIGN FOOTPATH	

**DAVIE LOVELL-SMITH**  
PLANNING SURVEYING ENGINEERING

115 Wrights Road  
P.O. Box 679 Christchurch 8142, New Zealand  
Telephone 03 379 4793 Website [www.dls.co.nz](http://www.dls.co.nz) E-mail [info@dls.co.nz](mailto:info@dls.co.nz)

**JOB TITLE**  
**South West Faringdon**  
**Stage 1**  
**RC 215485 & RC 215810**

**SHEET TITLE**  
**Earthworks Asbuilt**

**DRAWING STATUS**  
**Asbuilt**

SCALE: 1:500 @ A1	DATE: December 2021
CAD FILE: 1:1000 @ A3	
DRAWING NO:	SHEET NO:
<b>H.20256.AB.EW02</b>	
<b>R1</b>	

