

SS.18  
STD.MH1050  
IL1=34.29

FUTURE ROAD

DIMENSIONS TO SS LATERALS TO BE SHOWN  
WHEN LOTS ARE CREATED IN FUTURE STAGES

SS.105  
STD.MH1050  
LL=37.53  
IL1=34.02  
DROP STRUCTURE Ø150 IL2=34.89  
IL3=34.03  
DROP STRUCTURE Ø100 IL4=36.11  
DROP STRUCTURE Ø150 IL5=35.69

STAGE 6B

SS.1  
VENTED.MH1050  
LL=37.36  
IL1=35.41  
IL2=35.42

SS.2  
STD.MH1050  
LL=37.11  
IL1=36.05  
IL2=36.07

Lot 1  
DP 355996

491

420

419

418

417

416

415

414

413

SS.17  
STD.MH1050  
IL1=37.06

FUTURE ROAD

DIMENSIONS TO SS LATERALS TO BE SHOWN  
WHEN LOTS ARE CREATED IN FUTURE STAGES

STAGE 7A

SS.3  
VENTED.MH1050  
LL=38.02  
IL1=36.22  
IL2=36.23

FUTURE ROAD

LONGORE WAY

Lot 3  
DP 57004

495

494

493

491

504

503

502

501

500

499

498

497

496

495

494

493

492

491

AMENDMENTS :		
AMENDMENT	DATE	DESCRIPTION

- NOTES :
1. This plan has been prepared for sewer asbuilt purposes only. No liability is accepted if the plan is used for any other purpose.
  2. Any measurements taken from information which is not dimensioned on the electronic copy are at the risk of the recipient.
  3. All sewer laterals are 100mmØ uPVC SN16 unless shown otherwise specified.
  4. All asbuilt information on this sheet has been provided by Schick Civil Construction Ltd. and has not been verified. No liability is accepted in relation to their locations.
  5. All roading and footpath information is asbuilt.
  6. Origin of Levels:  
Levels are in terms of Mean Sea Level (Lyttelton Vertical Datum 1937) prior to Canterbury earthquakes of 2010 and 2011.

LEGEND

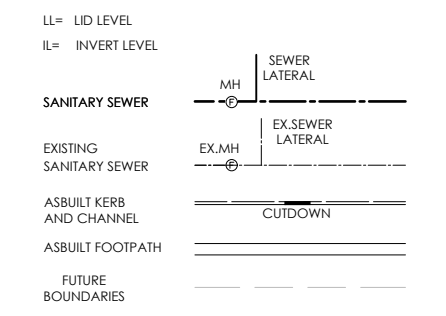

116 Wrights Road P O Box 679 Christchurch 8140. New Zealand  
Telephone: 03 379-0793 Website: www.dls.co.nz E-mail: office@dls.co.nz

JOB TITLE:  
**South West Faringdon  
Stage 5, 6A, 6B & 7A  
RC 215485 & 215965**

SHEET TITLE:  
**Sewer Asbuilt**

DRAWING STATUS:  
**Asbuilt**

SCALE: 1:500@A1 DATE: August 2022  
1:1000@A3

CAD FILE : J:\20575\ASBUILT\STAGE 5, 6A, 6B & 7A\H20575\_STG 5,6A,6B&7A\_AB\_NTM.DWG DRAWN : JS

DRAWING No : SHEET No : REVISION :  
**H.20575.AB.SS02 RO**



AMENDMENTS:		
AMENDMENT	DATE	DESCRIPTION

- NOTES:
1. This plan has been prepared for sewer asbuilt purposes only. No liability is accepted if the plan is used for any other purpose.
  2. Any measurements taken from information which is not dimensioned on the electronic copy are at the risk of the recipient.
  3. All sewer laterals are 100mmØ uPVC SN16 unless otherwise specified.
  4. All asbuilt information on this sheet has been provided by Schick Civil Construction Ltd and has not been verified. No liability is accepted in relation to their locations.
  5. All roading and footpath information is asbuilt.
  6. Origin of Levels:  
Levels are in terms of Mean Sea Level (Lyttelton Vertical Datum 1937) prior to Canterbury earthquakes of 2010 and 2011.

LEGEND

LL=	LID LEVEL
IL=	INVERT LEVEL
SANITARY SEWER	SEWER LATERAL
EXISTING SANITARY SEWER	EX. SEWER LATERAL
ASBUILT KERB AND CHANNEL	CUTDOWN
ASBUILT FOOTPATH	
FUTURE BOUNDARIES	

**DAVIE LOVELL-SMITH**  
PLANNING SURVEYING ENGINEERING

116 Wrights Road P O Box 679 Christchurch 8140. New Zealand  
Telephone: 03 379-0793 Website: www.dls.co.nz E-mail: office@dls.co.nz

JOB TITLE:  
**South West Faringdon  
Stage 5, 6A, 6B & 7A  
RC 215485 & 215965**

SHEET TITLE:  
**Sewer Asbuilt**

DRAWING STATUS:  
**Asbuilt**

SCALE: 1:500@A1 DATE: August 2022  
1:1000@A3

CAD FILE: J:\20575\ASBUILT\STAGE 5, 6A, 6B & 7A\H20575\_STG 5, 6A, 6B & 7A\_AB\_NZTM.dwg DRAWN: JS  
DRAWING No: SHEET No: REVISION:  
**H.20575.AB.SS03 RO**

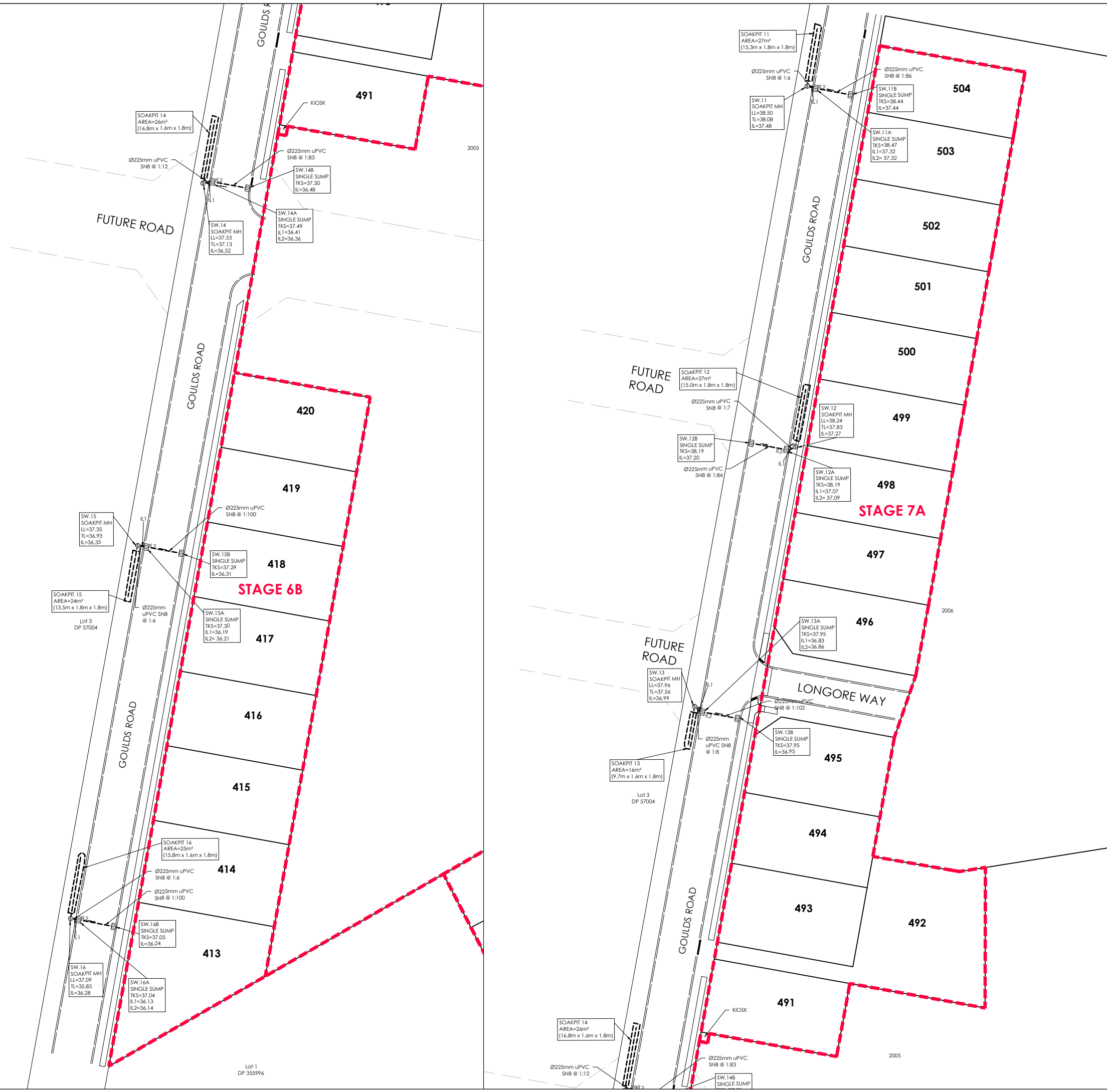
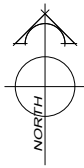

AMENDMENTS:		
AMENDMENT	DATE	DESCRIPTION

- NOTES:
1. This plan has been prepared for stormwater asbuilt purposes only. No liability is accepted if the plan is used for any other purpose.
  2. Any measurements taken from information which is not dimensioned on the electronic copy are at the risk of the recipient.
  3. All asbuilt information on this sheet has been provided by Schick Civil Construction Ltd and have not been verified. No liability is accepted in relation to their locations.
  4. All roading and footpath information is asbuilt.
  5. Origin of Levels:  
Levels are in terms of Mean Sea Level (Lyttelton Vertical Datum 1937) prior to Canterbury earthquakes of 2010 and 2011.

LEGEND

TKS=	TOP OF KERB AT SUMP
TL=	TIP LEVEL
STORMWATER	MH
EXISTING STORMWATER	EX.MH
ASBUILT KERB AND CHANNEL	SUMP DOUBLE SUMP CUTDOWN
ASBUILT FOOTPATH	SUMP DOUBLE SUMP CUTDOWN
FUTURE BOUNDARIES	SUMP DOUBLE SUMP CUTDOWN

**DAVIE LOVELL-SMITH**  
PLANNING SURVEYING ENGINEERING

116 Wrights Road P O Box 679 Christchurch 8140. New Zealand  
Telephone: 03 379-0793 Website: www.dls.co.nz E-mail: office@dls.co.nz

JOB TITLE:  
**South West Faringdon  
Stage 5, 6A, 6B & 7A  
RC 215485 & 215965**

SHEET TITLE:  
**Stormwater Asbuilt**

DRAWING STATUS:  
**Asbuilt**

SCALE: 1:500@A1 DATE: August 2022  
1:1000@A3

CAD FILE: J:\20575\ASBUILT\STAGE 5, 6A, 6B & 7A\H20575\_STG 5,6A,6B&7A\_AB\_NZTM.dwg DRAWN: JS

DRAWING No: H.20575.AB.SW02 SHEET No: RO REVISION:

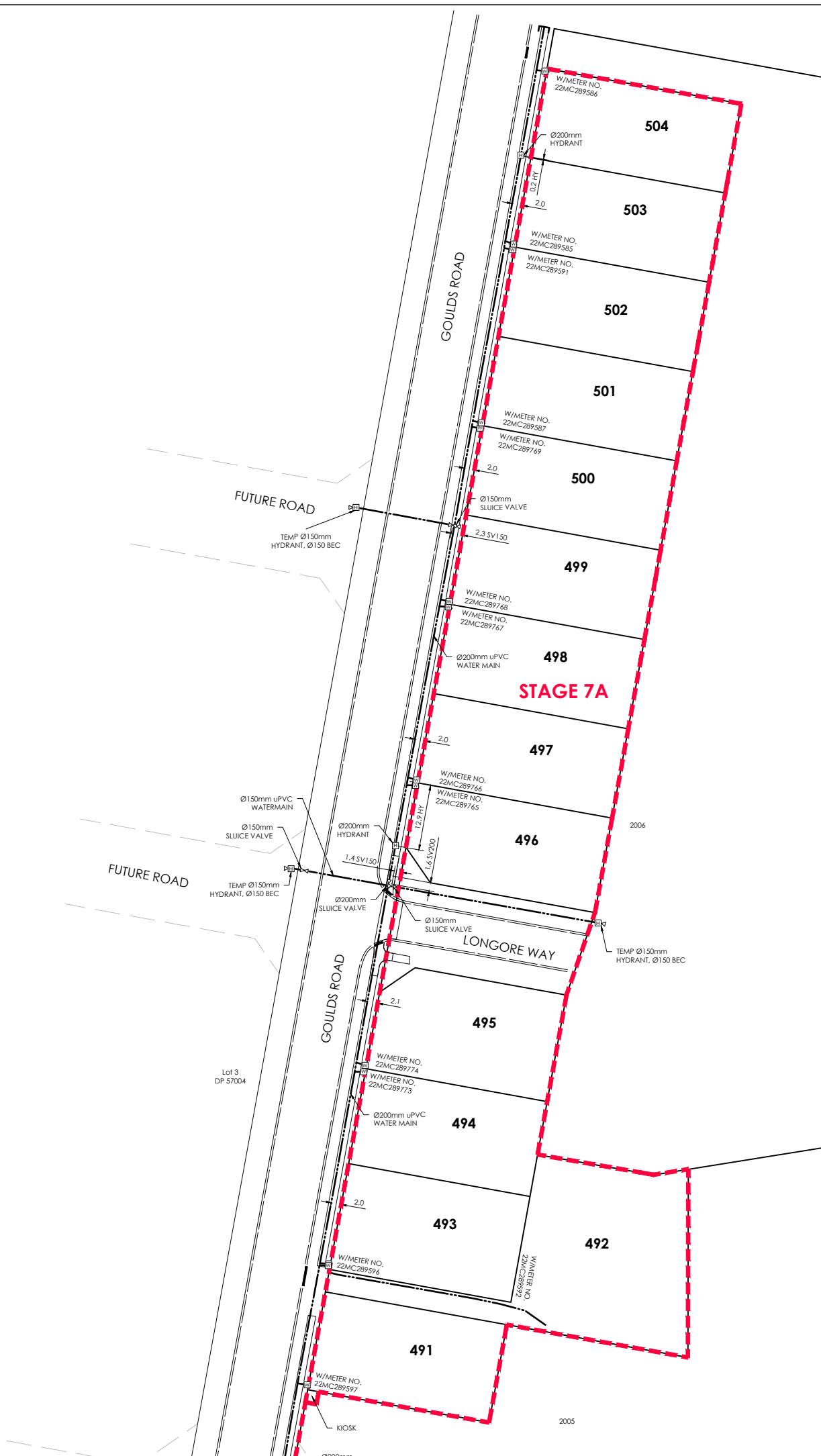
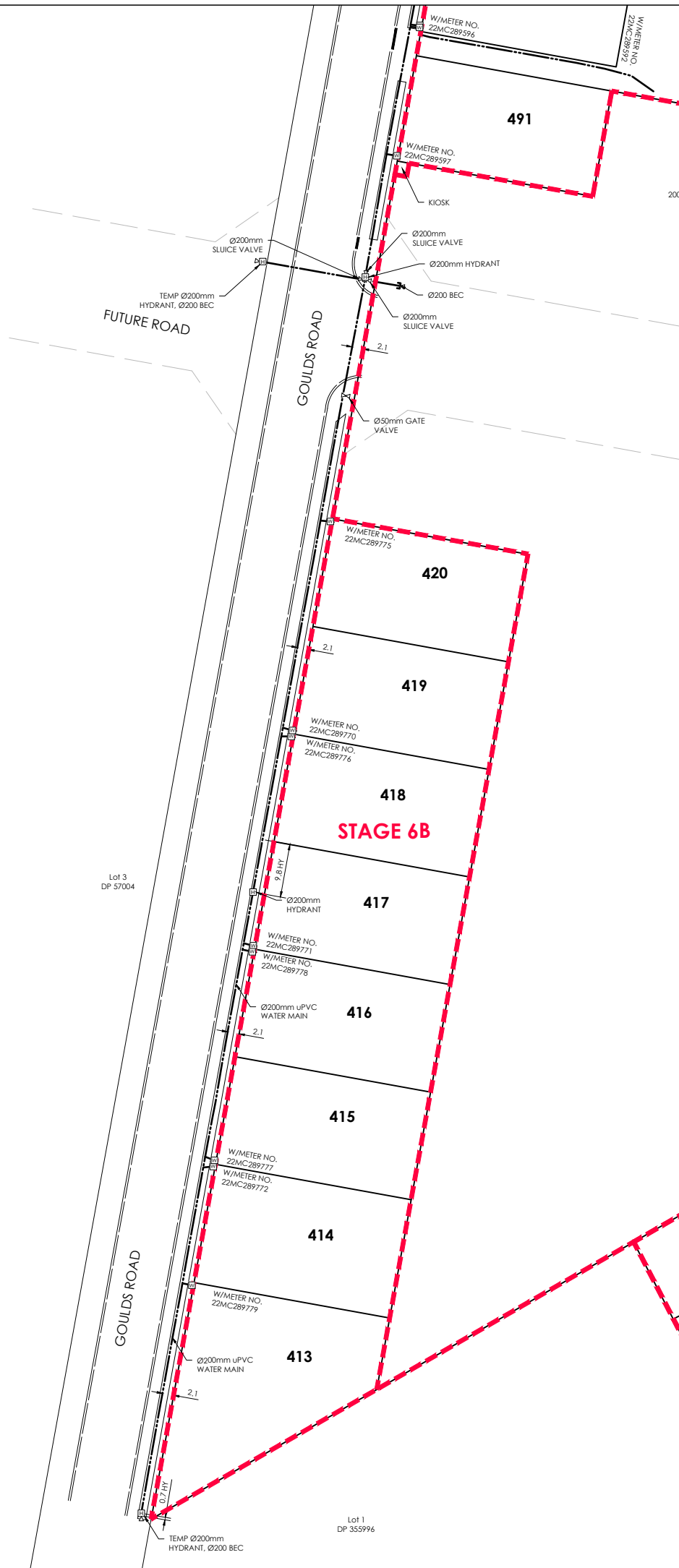
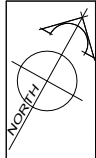

AMENDMENTS:		
AMENDMENT	DATE	DESCRIPTION

- NOTES:
1. This plan has been prepared for water asbuilt purposes only. No liability is accepted if the plan is used for any other purpose.
  2. Any measurements taken from information which is not dimensioned on the electronic copy are at the risk of the recipient.
  3. The asbuilt locations of all water mains, fire hydrants and valves on this sheet have been provided by Schick Civil Construction Ltd. No liability is accepted in relation to their accuracy or their location.
  4. All house connections are 25mm poly and include gate valve, toby box, tapping band and ferrule.
  5. All water laterals are Ø25mm PE BlueLine PN12.5 with associated fittings unless otherwise specified.
  6. All roading and footpath information is asbuilt.

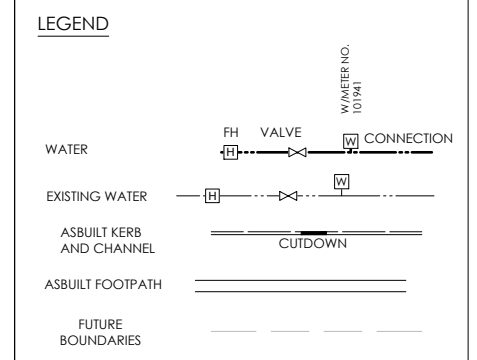

**DAVIE LOVELL-SMITH**  
 PLANNING SURVEYING ENGINEERING

116 Wrights Road P O Box 679 Christchurch 8140. New Zealand  
 Telephone: 03 379-0793 Website: www.dls.co.nz E-mail: office@dls.co.nz

JOB TITLE:  
**South West Faringdon  
 Stage 5, 6A, 6B & 7A  
 RC 215485 & 215965**

SHEET TITLE:  
**Water Asbuilt**

DRAWING STATUS:  
**Asbuilt**

SCALE: 1:500@A1 DATE: August 2022  
 1:1000@A3

CAD FILE: J:\20575\Asbuilt\STAGE 5, 6A, 6B & 7A\H20575\_STG 5,6A,6B&7A\_AB\_H2TM.DWG DRAWN: JS  
 DRAWING No: SHEET No: REVISION:  
**H.20575.AB.WS02 RO**



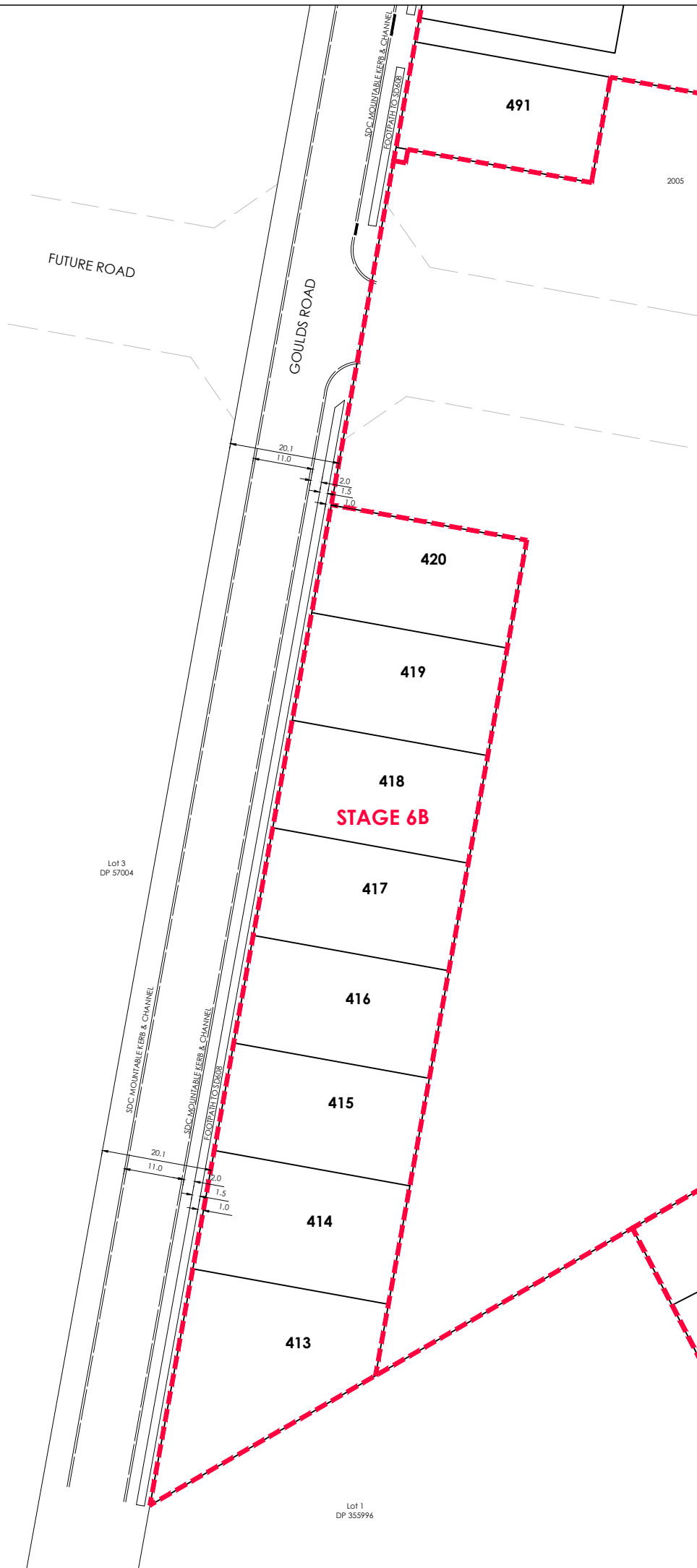
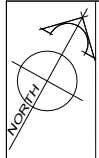

AMENDMENTS:		
AMENDMENT	DATE	DESCRIPTION

- NOTES:
1. This plan has been prepared for road asbuilt purposes only. No liability is accepted if the plan is used for any other purpose.
  2. Any measurements taken from information which is not dimensioned on the electronic copy are at the risk of the recipient.
  3. Carriageway dimensions shown are from face of kerb to face of kerb.

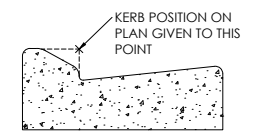

MOUNTABLE KERB & CHANNEL

LEGEND	
COBBLES	
EXPOSED AGGREGATE	
ASBUILT KERB AND CHANNEL	
ASBUILT FOOTPATH	
FUTURE BOUNDARIES	

**DAVIE LOVELL-SMITH**  
PLANNING SURVEYING ENGINEERING

116 Wrights Road P O Box 679 Christchurch 8140. New Zealand  
Telephone: 03 379-0793 Website: www.dls.co.nz E-mail: office@dls.co.nz

JOB TITLE:  
**South West Faringdon  
Stage 5, 6A, 6B & 7A  
RC 215485 & 215965**

SHEET TITLE:  
**Roading Asbuilt**

DRAWING STATUS:  
**Asbuilt**

SCALE: 1:500@A1 DATE: August 2022  
1:1000@A3

CAD FILE : J:\20575\Asbuilt\STAGE 5, 6A, 6B & 7A\H20575\_STG 5,6A,6B&7A\_AB\_NBTM.DWG DRAWN : JS

DRAWING No: SHEET No: REVISION:  
**H.20575.AB.RD02 RO**