

SS.18
STD.MH1050
IL1=34.29

FUTURE ROAD

DIMENSIONS TO SS LATERALS TO BE SHOWN
WHEN LOTS ARE CREATED IN FUTURE STAGES

SS.105
STD.MH1050
LL=37.53
IL1=34.02
DROP STRUCTURE Ø150 IL2=34.89
IL3=34.03
DROP STRUCTURE Ø100 IL4=36.11
DROP STRUCTURE Ø150 IL5=35.69

STAGE 6B

SS.1
VENTED.MH1050
LL=37.36
IL1=35.41
IL2=35.42

SS.2
STD.MH1050
LL=37.11
IL1=36.05
IL2=36.07

Lot 1
DP 355996

491

SS.70
STD.MH1050
IL1=35.37

FUTURE ROAD

DIMENSIONS TO SS LATERALS TO BE SHOWN
WHEN LOTS ARE CREATED IN FUTURE STAGES

STAGE 7A

SS.3
VENTED.MH1050
LL=38.02
IL1=36.22
IL2=36.23

LONGORE WAY

Lot 3
DP 57004

491

504

503

502

501

500

499

498

497

496

495

494

493

492

491

AMENDMENTS :		
AMENDMENT	DATE	DESCRIPTION

- NOTES :
1. This plan has been prepared for sewer asbuilt purposes only. No liability is accepted if the plan is used for any other purpose.
 2. Any measurements taken from information which is not dimensioned on the electronic copy are at the risk of the recipient.
 3. All sewer laterals are 100mmØ uPVC SN16 unless shown otherwise specified.
 4. All asbuilt information on this sheet has been provided by Schick Civil Construction Ltd. and has not been verified. No liability is accepted in relation to their locations.
 5. All roading and footpath information is asbuilt.
 6. Origin of Levels:
Levels are in terms of Mean Sea Level (Lyttelton Vertical Datum 1937) prior to Canterbury earthquakes of 2010 and 2011.

LEGEND

LL= LID LEVEL
IL= INVERT LEVEL

SANITARY SEWER: MH, SEWER LATERAL

EXISTING SANITARY SEWER: EX.MH, EX. SEWER LATERAL

ASBUILT KERB AND CHANNEL: CUTDOWN

ASBUILT FOOTPATH

FUTURE BOUNDARIES

DAVE LOVELL-SMITH
PLANNING SURVEYING ENGINEERING

116 Wrights Road P O Box 679 Christchurch 8140. New Zealand
Telephone: 03 379-0793 Website: www.dls.co.nz E-mail: office@dls.co.nz

JOB TITLE:
**South West Faringdon
Stage 5, 6A, 6B & 7A
RC 215485 & 215965**

SHEET TITLE:
Sewer Asbuilt

DRAWING STATUS:
Asbuilt

SCALE: 1:500@A1 DATE: August 2022
1:1000@A3

CAD FILE : J:\20575\ASBUILT\STAGE 5, 6A, 6B & 7A\H20575_STG 5,6A,6B&7A_AB_NZTM.DRAWN : JS

DRAWING No : SHEET No : REVISION :
H.20575.AB.SS02 RO



AMENDMENTS :		
AMENDMENT	DATE	DESCRIPTION

- NOTES:
1. This plan has been prepared for sewer asbuilt purposes only. No liability is accepted if the plan is used for any other purpose.
 2. Any measurements taken from information which is not dimensioned on the electronic copy are at the risk of the recipient.
 3. All sewer laterals are 100mmØ uPVC SN16 unless otherwise specified.
 4. All asbuilt information on this sheet has been provided by Schick Civil Construction Ltd and has not been verified. No liability is accepted in relation to their locations.
 5. All roading and footpath information is asbuilt.
 6. Origin of Levels:
Levels are in terms of Mean Sea Level (Lyttelton Vertical Datum 1937) prior to Canterbury earthquakes of 2010 and 2011.

LEGEND

LL=	LID LEVEL	
IL=	INVERT LEVEL	
SANITARY SEWER		
EXISTING SANITARY SEWER		
ASBUILT KERB AND CHANNEL		
ASBUILT FOOTPATH		
FUTURE BOUNDARIES		

DAVIE LOVELL-SMITH
PLANNING SURVEYING ENGINEERING

116 Wrights Road P O Box 679 Christchurch 8140. New Zealand
Telephone: 03 379-0793 Website: www.dls.co.nz E-mail: office@dls.co.nz

JOB TITLE:
**South West Faringdon
Stage 5, 6A, 6B & 7A
RC 215485 & 215965**

SHEET TITLE:
Sewer Asbuilt

DRAWING STATUS:
Asbuilt

SCALE: 1:500@A1 DATE: August 2022
1:1000@A3

CAD FILE : J:\20575\ASBUILT\STAGE 5, 6A, 6B & 7A\H20575_STG 5, 6A, 6B & 7A_AB_NZTM.DWG DRAWN : JS

DRAWING No: SHEET No: REVISION :
H.20575.AB.SS03 RO

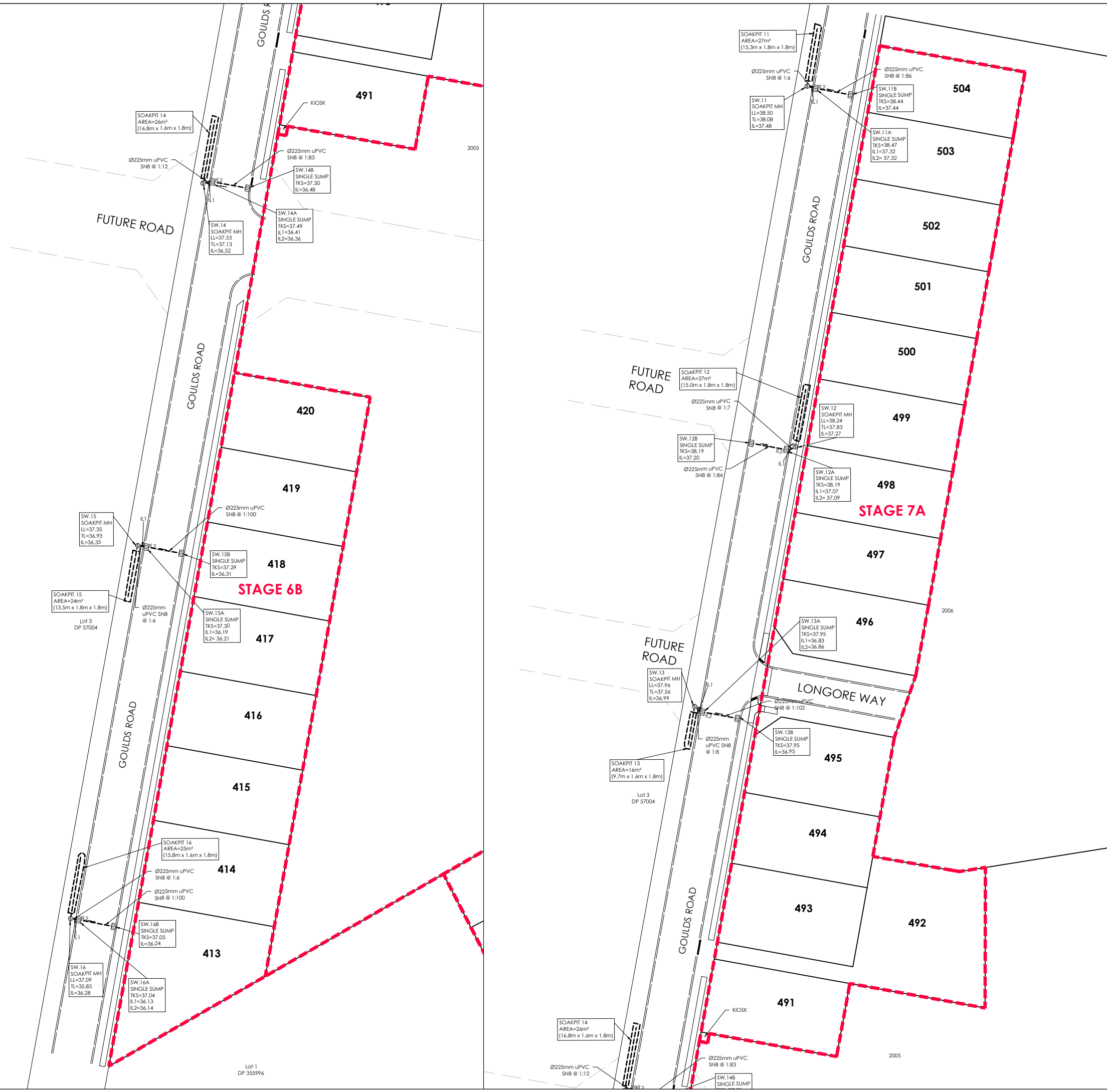
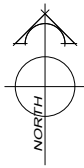

AMENDMENTS:		
AMENDMENT	DATE	DESCRIPTION

- NOTES:
1. This plan has been prepared for stormwater asbuilt purposes only. No liability is accepted if the plan is used for any other purpose.
 2. Any measurements taken from information which is not dimensioned on the electronic copy are at the risk of the recipient.
 3. All asbuilt information on this sheet has been provided by Schick Civil Construction Ltd and have not been verified. No liability is accepted in relation to their locations.
 4. All roading and footpath information is asbuilt.
 5. Origin of Levels:
Levels are in Terms of Mean Sea Level (Lyttelton Vertical Datum 1937) prior to Canterbury earthquakes of 2010 and 2011.

LEGEND

TKS=	TOP OF KERB AT SUMP
TL=	TIP LEVEL
STORMWATER	
EXISTING STORMWATER	
ASBUILT KERB AND CHANNEL	
ASBUILT FOOTPATH	
FUTURE BOUNDARIES	

DAVIE LOVELL-SMITH
PLANNING SURVEYING ENGINEERING

116 Wrights Road P O Box 679 Christchurch 8140. New Zealand
Telephone: 03 379-0793 Website: www.dls.co.nz E-mail: office@dls.co.nz

JOB TITLE:
**South West Faringdon
Stage 5, 6A, 6B & 7A
RC 215485 & 215965**

SHEET TITLE:
Stormwater Asbuilt

DRAWING STATUS:
Asbuilt

SCALE: 1:500@A1 DATE: August 2022
1:1000@A3

CAD FILE: J:\20575\ASBUILT\STAGE 5, 6A, 6B & 7A\H20575_STG 5,6A,6B&7A_AB_NZTM.dwg DRAWN: JS

DRAWING No: H.20575.AB.SW02 SHEET No: RO REVISION:

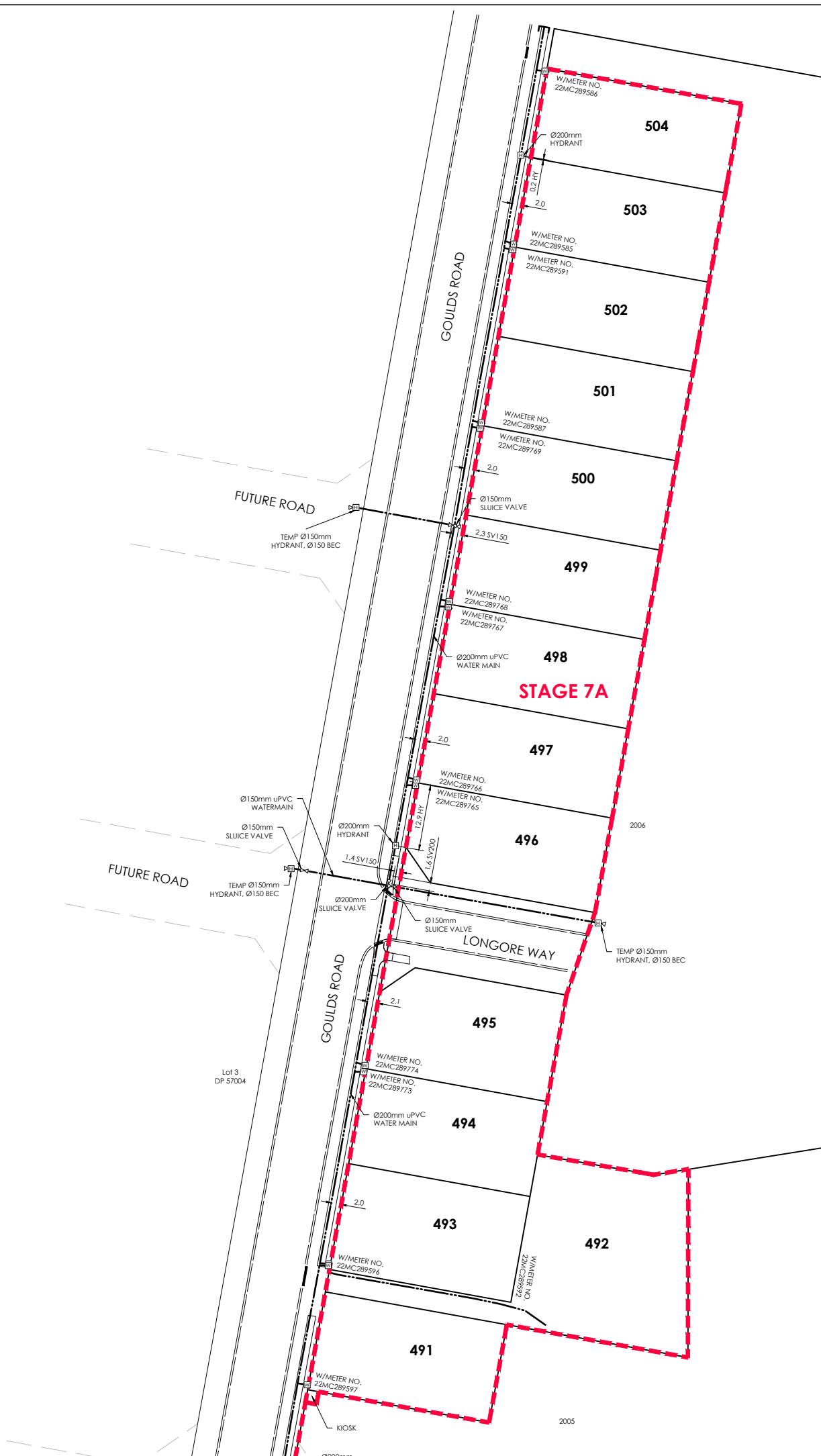
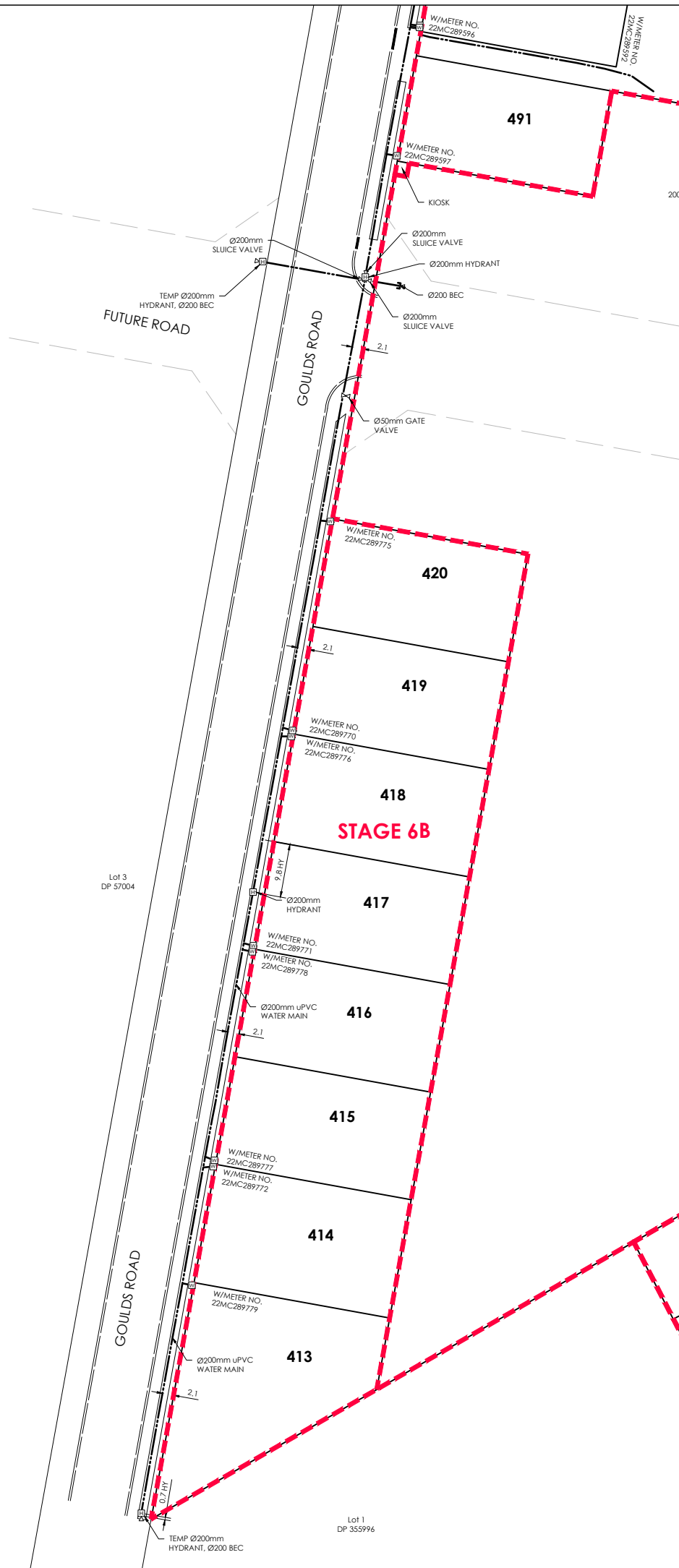
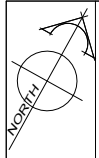

AMENDMENTS:		
AMENDMENT	DATE	DESCRIPTION

- NOTES:
1. This plan has been prepared for water asbuilt purposes only. No liability is accepted if the plan is used for any other purpose.
 2. Any measurements taken from information which is not dimensioned on the electronic copy are at the risk of the recipient.
 3. The asbuilt locations of all water mains, fire hydrants and valves on this sheet have been provided by Schick Civil Construction Ltd. No liability is accepted in relation to their accuracy or their location.
 4. All house connections are 25mm poly and include gate valve, toby box, tapping band and ferrule.
 5. All water laterals are Ø25mm PE BlueLine PN12.5 with associated fittings unless otherwise specified.
 6. All roading and footpath information is asbuilt.

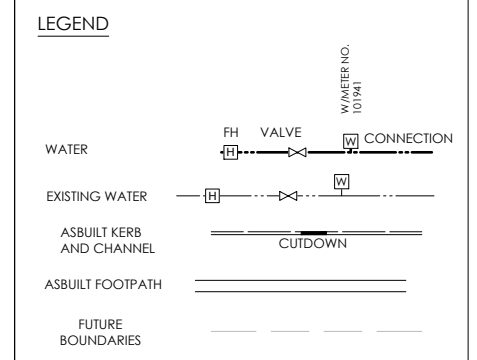

DAVIE LOVELL-SMITH
 PLANNING SURVEYING ENGINEERING

116 Wrights Road P O Box 679 Christchurch 8140. New Zealand
 Telephone: 03 379-0793 Website: www.dls.co.nz E-mail: office@dls.co.nz

JOB TITLE:
**South West Faringdon
 Stage 5, 6A, 6B & 7A
 RC 215485 & 215965**

SHEET TITLE:
Water Asbuilt

DRAWING STATUS:
Asbuilt

SCALE: 1:500@A1 DATE: August 2022
 1:1000@A3

CAD FILE: J:\20575\Asbuilt\STAGE 5, 6A, 6B & 7A\H20575_STG 5,6A,6B&7A_AB_H2TM.DWG DRAWN: JS
 DRAWING No: SHEET No: REVISION:
H.20575.AB.WS02 RO

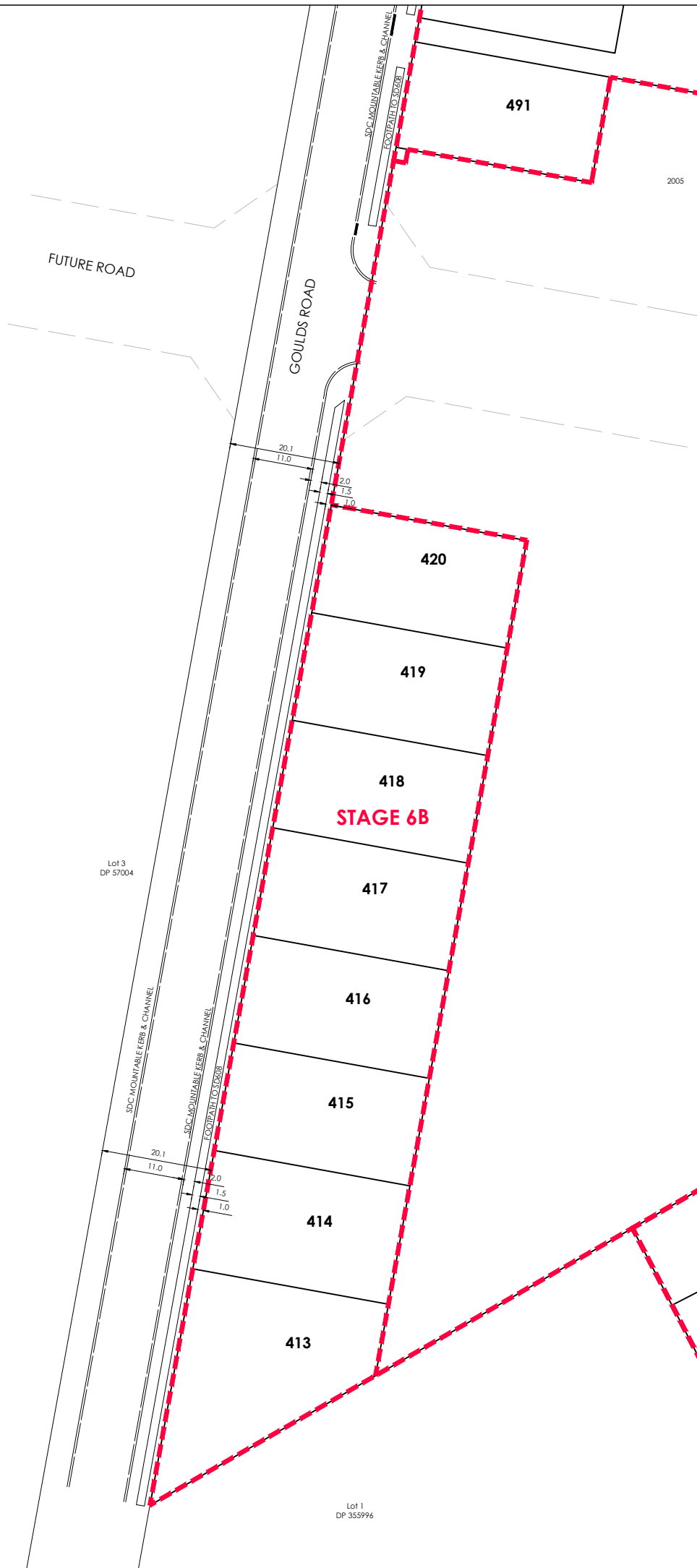
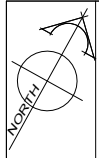

AMENDMENTS:		
AMENDMENT	DATE	DESCRIPTION

- NOTES:
1. This plan has been prepared for road asbuilt purposes only. No liability is accepted if the plan is used for any other purpose.
 2. Any measurements taken from information which is not dimensioned on the electronic copy are at the risk of the recipient.
 3. Carriageway dimensions shown are from face of kerb to face of kerb.

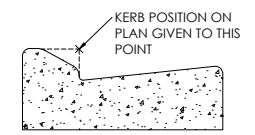

MOUNTABLE KERB & CHANNEL

LEGEND	
COBBLES	
EXPOSED AGGREGATE	
ASBUILT KERB AND CHANNEL	
ASBUILT FOOTPATH	
FUTURE BOUNDARIES	

DAVIE LOVELL-SMITH
PLANNING SURVEYING ENGINEERING

116 Wrights Road P O Box 679 Christchurch 8140. New Zealand
Telephone: 03 379-0793 Website: www.dls.co.nz E-mail: office@dls.co.nz

JOB TITLE:
**South West Faringdon
Stage 5, 6A, 6B & 7A
RC 215485 & 215965**

SHEET TITLE:
Roading Asbuilt

DRAWING STATUS:
Asbuilt

SCALE: 1:500@A1 DATE: August 2022
1:1000@A3

CAD FILE : J:\20575\Asbuilt\STAGE 5, 6A, 6B & 7A\H20575_STG 5,6A,6B&7A_AB_NBTM.DRAWN : JS

DRAWING No: SHEET No: REVISION:
H.20575.AB.RD02 RO